

**Diesel Generating Set TNPS-1375**

60Hz

**General Features**

- Engine 4012-46TWG2A Perkins Made in UK
- Alternator LVI634F Stamford Made in China
- Controller DSE7320 Deepsea Made in UK



Prime power	1000.0kW/1250.0k
Standby power	1100kW/1375.0kV



- Electric speed control
- 24v starting batteries, maintenance-free type, connecting cables
- Equipped with CHINT MCCB; ABB in Option
- Equipped with industrial silencer and flexible exhaust hose
- Radiator 40°C max, fans are driven by belt with safety guard
- 24v charge dynamo
- Equipped with 8-hours operation base tank
- Design comply to ISO8528/GB2820
- Absorber (anti instant braking)
- User manual, Packing list

**General Ratings**

Voltage	Power				Frequency (Hz)	Phase	P.F (COSφ)	Prime Current (A)
	Prime		Standby					
	kw	kva	kw	kva				
220/380V	1000.0	1250.0	1100.0	1375.0	60	3	0.8	1899.2
230/400V	1000.0	1250.0	1100.0	1375.0	60	3	0.8	1804.3
240/415V	1000.0	1250.0	1100.0	1375.0	60	3	0.8	1739.1
254/440V	1000.0	1250.0	1100.0	1375.0	60	3	0.8	1640.2

**Prime power**

This rating is for the supply of continuous electrical power at variable load. A 10% overload capability is available for a period of 1 hour within each 12-hour period of operation.

**Standby power**

This rating is for the supply of continuous electrical power at variable load in the event of utility power failure. No overload is permitted.

**Rated voltage**

Available with customers requirements.

**Sales Promise**

TANON POWER provides a full line of 100% brand new and high quality products.

Each and every unit is strictly factory tested before delivery.

Warranty is according to below standard conditions, subject to the earlier one.

1. 13 months, counted on the day TANON POWER sold to the first buyer.
2. One year after installation.
3. 1000 running hours.

Service and parts are available from TANON POWER or distributors in your location.

**Dimension And Weight**

**Open frame**  
Size(L\*W\*H):4500\*1800\*2250(mm)  
N.W.:10000 (kgs)

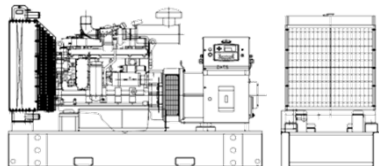

**Silent with Canopy**  
Size(L\*W\*H):20" container  
N.W.:12500(kas)

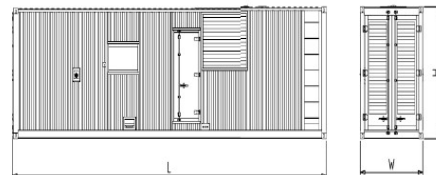

**Engine Specifications**

1	Engine model	4012-46TWG2A
2	Engine manufacturer	Perkins UK
3	Number of cylinders	12
4	Cylinder arrangement	60° Vee form
5	Cycle	4 stroke
6	Aspiration	Turbo
7	Bore×Stroke(mm×mm)	160 x 190
8	Displacement (Liter)	45.842
9	Compression Ratio	13.6:1
10	Prime power/speed (kW/RPM)	1155/1800RPM
11	Standby power/speed (kW/RPM)	1304/1800RPM
12	Speed governor	Electric
13	Cooling system	Water-cooled
14	Coolant capacity (engine only) (L)	196.0
15	Steady speed droop (%)	≤5%
16	Total lubrication system capacity (L)	177.0
17	Oil consumption (% of fuel)	<0.15%
18	Fuel consumption at 100% load (L/h)	259.0
19	Fuel consumption at 75% load (L/h)	196.0
20	Fuel consumption at 50% load (L/h)	143.0
21	Starter motor	24v
22	Dynamo	24v

**Alternator Specifications**

Compliance with GB755,BS5000,VDE0530,NEMAMG1-22,IED34-1,CSA22.2 and AS1359

1	Alternator model and Prime Power	LVI634F
2	Alternator manufacturer	Stamford
3	Exciter type	Single bearing, Brushless, Self-excited
4	Rated speed	1800 RPM
5	Rated frequency	60 Hz
6	Phase	3
7	Rated voltage	440V
8	Power factor	0.8
9	Voltage adjust range	≥5%
10	Voltage regulation NL-FL	±1%
11	Insulation grade	H
12	Protection grade	IP23

**Alternator option**

Mecc Alte, Stamford, TANON POWER

**Main Electrical Performance Data**

Voltage				Frequency			
Stable Regulation rate	Fluctuation	Recover time	Instantaneous Regulating rate	Stable regulation rate	Instantaneous regulating rate	Recover time	Fluctuation
+/-2.5%	0.5%	1.5s	+20%/-15%	+5%	+/-10%	5S	0.5%

Control System

Deepsea (UK)	Model	DSE7320
Protection	Parameter	PHOTO
● Low oil pressure	● Volt	
● High water temp	● current	
● Over speed	● power	
● over crank	● speed	
● Over load	● frequency	
● Over/low volt		
● Over/low frequency		
● Battery charge failure		
	● oil pressure	
	● oil temp	
	● power factor	
	● running time	
	● water temp	
	● battery voltage	

Option

Generator Set

- Trailer generator set
- ABB MCCB circuit breaker
- 50°C Radiator

Fuel system

- 12 hours base fuel tank
- 24 hours base fuel tank
- Dual wall base fuel tank
- External fuel tank

Exhaust system

- Residential exhaust silencer

Alternator

- PMG excitation
- Anti Condensation Heater

For cold area

- Water heater
- Oil heater
- Rapid water preheater (diesel burner)

Auto system

- Remote Control panel
- ATS control cabinet
- Paralleling System

External ATS



220V water heater

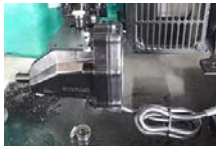

Diesel powered heater



220V Oil heated Syn. Cabinet



Parker separator



TANON POWER reserves the right to change the specifications and design without notice.